

Tilting Maze

A DIY gravity game

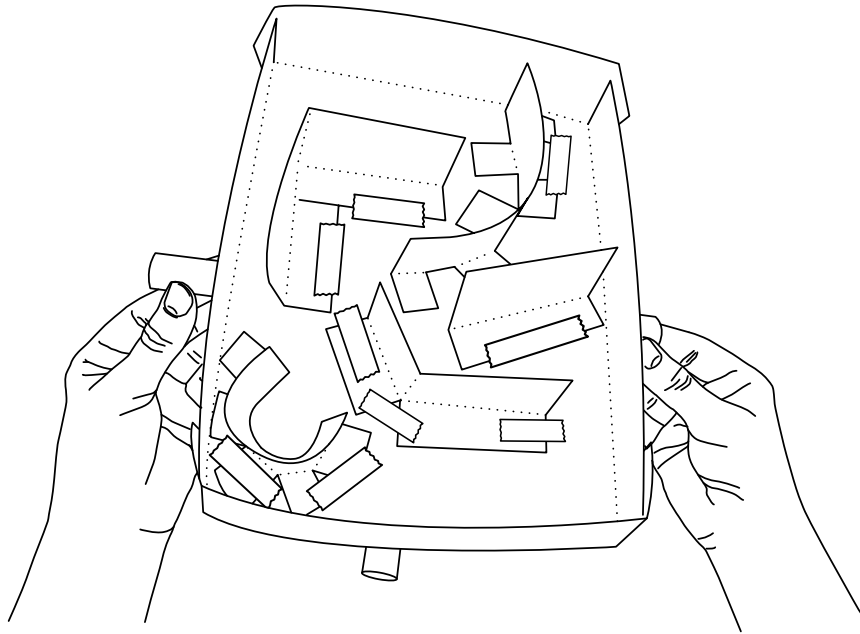
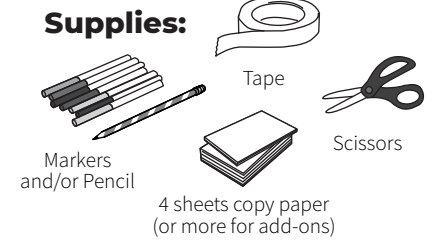

Build a tilting maze.
Experiment with
gravitational forces
through play.

Add barriers, tunnels,
goals & more!

Adjust & Add On

Here are a few ideas for components
to add to your tilting maze!

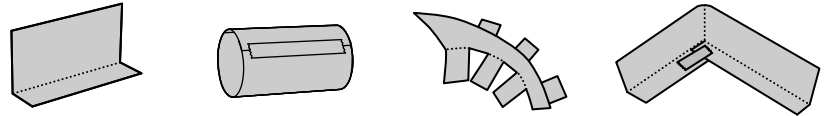

Paper Ball



Crumple a scrap of
paper into a ball

Straight Barrier

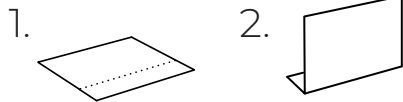

1. Fold approximately
1/4 from edge

2. Fold and
stand upright

Curved Barrier

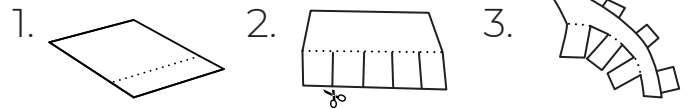

1. Fold approximately
1/4 from edge

2. Cut slits from edge to
fold line

3. Fold flaps to
opposite sides

Tunnel



1. Put tape on one
edge of paper

2. Bring taped edge
over the other edge

Corner Barrier

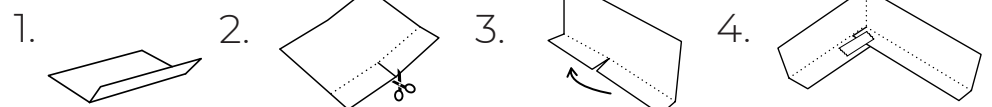

1. Crease approximately
1/4 from edge

2. Cut slit from edge of
paper to fold line

3. Overlap flaps to
make a corner

4. Overlap flaps and
tape in place

Create a Tilting Maze

Supplies:



Tape

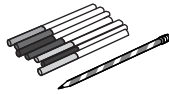

Markers
and/or Pencil



Scissors



4 sheets copy paper
(or more for
add-ons)

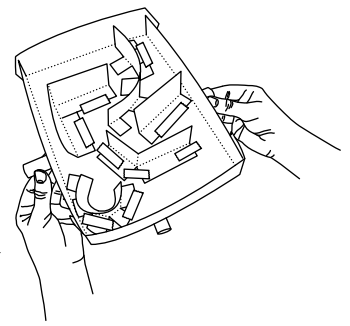

Assemble Tray



Use 1 sheet of
copy paper

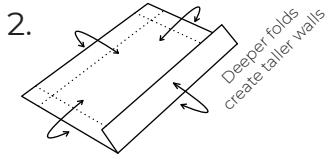

Crease all 4 edges
inward to make walls

Deeper folds
create taller walls

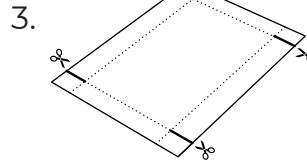

Cut slits from edge of paper to
intersection of fold lines

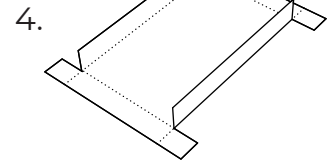

Fold edges up to
make walls

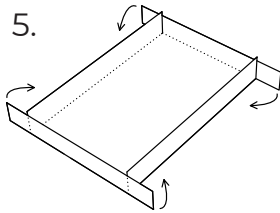

Fold tabs inward

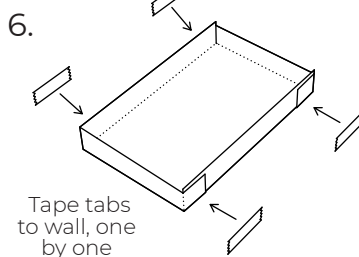

Tape tabs
to wall, one
by one

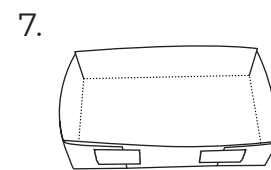

Finished tray

Add Barriers

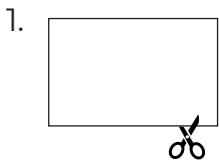

Use 1 sheet of
copy paper

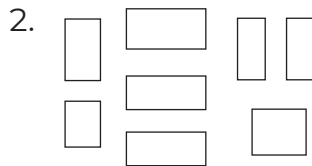

Cut paper into rectangles
of different dimensions

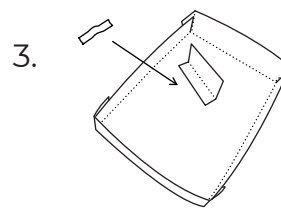

Make barriers, tape to tray

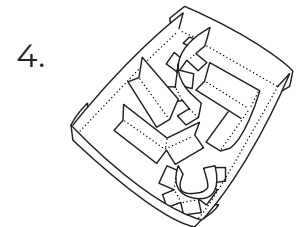

Create maze

Make Handle

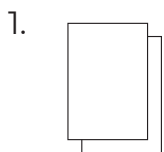

Use 2 sheets of
copy paper

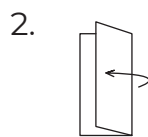

Fold each sheet
in half, **long edge
to long edge**

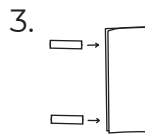

Place tape
sticky side up
on open edge of
folded sheet

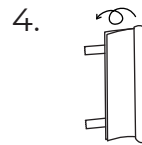

Tightly roll folded
sheet into a tube

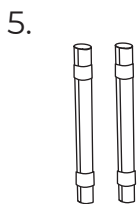

Make two
tubes

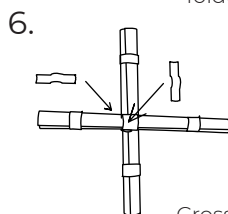

Cross segments,
tape them together
on front and back

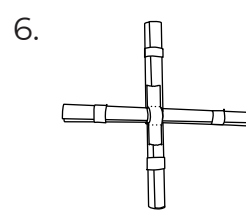

Finished
handle

Assemble

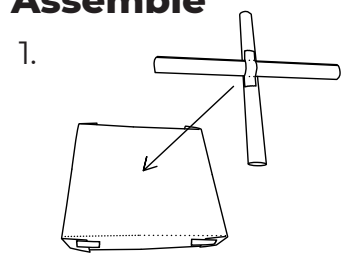

Place handle on back of tray

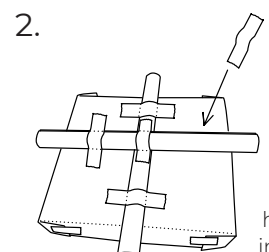

Tape
handle
in place